

FRONT

WARNING: Discard and replace at the first sign of weakness or damage. Do not leave child unattended. This is not a toy, adult use only. Discard all packaging components before use.

PRODUCT AND DESIGN ARE TM & ©2013 MUNCHKIN, INC. MUNCHKIN, THE LATCH LOGO AND IT'S THE LITTLE THINGS ARE TRADEMARKS OR REGISTERED TRADEMARKS OF MUNCHKIN, INC. 7835 GLORIA AVE., VAN NUYS, CA 91406. PATENT: [HTTP://WWW.MUNCHKIN.COM/PATENTS](http://www.munchkin.com/patents). MADE IN CHINA.

Medela is a registered trademark of Medela Holding AG Corporation, Lansinoh is a trademark of Lansinoh Laboratories, Inc. and Evenflo is a trademark of Evenflo Company, Inc. None of these companies are affiliated or endorsed by Munchkin, Inc.

munchkin.
It's the little things.

munchkin.com
800.344.2229



munchkin
LATCH™
Breast Pump Adapter
Instructions

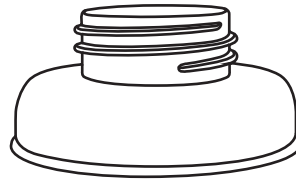

See how it works at
latchbottles.com

CCD-0134-001 REV1

BACK

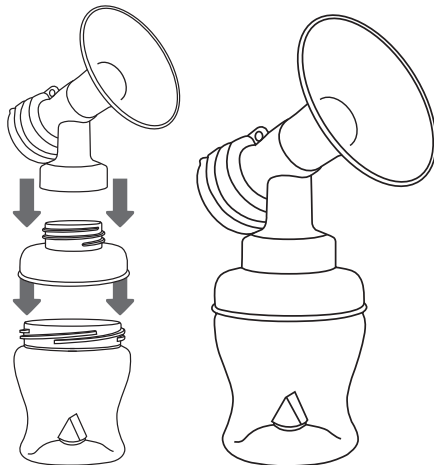

Sterilizing Before Use: Before first use, place adapter in boiling water for 5 minutes or use the Munchkin® SteamGuard™ Microwave or Electric Sterilizer for proper hygiene.

To Clean: Wash before use. Disassemble the adapter from the Munchkin® LATCH™ bottle and breast pump cone. Wash with soap and rinse thoroughly. Safe to sterilize using a sterilizer or boil for 5 minutes. Top rack dishwasher safe. Use dishwasher basket to secure components during wash and dry cycles. Do not microwave.

Assembly: Screw the wider end of the adapter to the bottle by twisting to the right. Screw the pump connector into the narrow end of the adapter by twisting to the right.

Compatibility: The Munchkin® LATCH™ breast pump adapter is compatible with leading breast pumps, including many Medela®, Lansinoh®, and Evenflo® pumps.