

FRONT

Nipple Dishwasher Cleaner (Not included in all gift sets)

To Clean: Wash before use. Do not microwave, boil or steam sterilize. Top rack dishwasher safe.

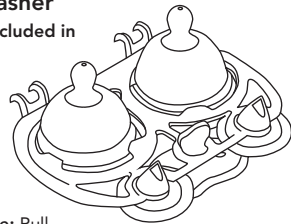

Instructions for use: Pull nipples and pacifier up into slots as shown, ensuring that nipples sit upright. Slide valves into curved ridges. Snap the rack into available top-level area of the dishwasher. For optimal cleaning, do not place any dishware directly under Nipple Dishwasher Cleaner.

WARNING: Discard and replace at the first sign of weakness or damage. Do not leave child unattended. These items are not toys, adult use only. Discard all packaging components before use.

PRODUCT AND DESIGN ARE TM & ©2013 MUNCHKIN, INC. MUNCHKIN, THE LATCH LOGO AND IT'S THE LITTLE THINGS ARE TRADEMARKS OR REGISTERED TRADEMARKS OF MUNCHKIN, INC. 7835 GLORIA AVE., VAN NUYS, CA 91406. PATENT: [HTTP://WWW.MUNCHKIN.COM/PATENTS](http://www.munchkin.com/patents). MADE IN CHINA.

Medela is a registered trademark of Medela Holding AG Corporation, Lansinoh is a trademark of Lansinoh Laboratories, Inc. and Evenflo is a trademark of Evenflo Company, Inc. None of these companies are affiliated or endorsed by Munchkin, Inc.



munchkin
LATCH™
Accessories Instructions

Instructions for:

- Breast Pump Adapter
- Nipple Dishwasher Cleaner
- Deluxe Bottle & Valve Brush

See how it works at latchbottles.com

CCD-0134-000 REV1



BACK

Breast Pump Adapter

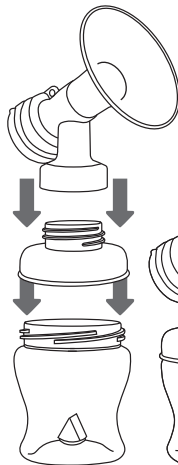

Sterilizing Before Use: Before first use, place adapter in boiling water for 5 minutes or use the Munchkin®

SteamGuard™ Microwave or Electric Sterilizer for proper hygiene.

To Clean: Wash before use. Disassemble the adapter from the Munchkin® LATCH™ bottle and breast pump cone. Wash with soap and rinse thoroughly. Safe to

sterilize using a sterilizer or boil for 5 minutes. Top rack dishwasher safe. Use dishwasher basket to secure components during wash and dry cycles. Do not microwave.

Assembly: Screw the wider end of the adapter to the bottle by twisting to the right. Screw the pump connector into the narrow end of the adapter by twisting to the right.

Compatibility: The Munchkin LATCH™ breast pump adapter is compatible with leading breast pumps, including many Medela, Lansinoh, and Evenflo pumps.

Deluxe Bottle & Valve Brush

To Clean: Wash before use. Do not microwave, boil or steam sterilize. Top rack dishwasher safe.

Instructions For Use: Remove valve brush from base of Deluxe Bottle & Valve Brush by twisting to the left. After removing the valve from the base of the

Munchkin LATCH™ bottle, gently sweep the valve brush through the valve using soap and water. With soap and water, use the Bottle Brush to scrub the nipple and bottle ensuring that the bristles reach between nipple flanges for thorough cleaning. Always allow brush to completely dry before storing. To help reduce germ build-up, bottle brushes should be replaced every 30-45 days or at first sign of wear.

